

**GENERAL BATHROOM NOTES:**  
 Shower compartments shall have at least 400 sq. in. of floor area and be of sufficient size to inscribe a circle with a dia. not less than 30 in. Hinged shower doors shall open outward. The wall area above built-in tubs having installed shower heads and in-shower compartments shall be constructed as per Section R1202.4. Such walls shall form a watertight joint with each other and with either the tub, receptor or shower floor. Bathrooms, water closet compartments, and other similar rooms shall be provided with aggregate grouting area in windows of not less than 3 sq. ft., one half of which must be operable. (if no windows, a mechanical ventilation system shall be req.). The min. ventilation rates shall be 50 cfm. for continuous ventilation.

ALL exterior doors shall have a floor of landing on each side of the door. The floor on landing at a door shall not be more than 1/2 inch lower than the top of the threshold. If the door is not a req. exit door the landing shall not exceed 8" from top of threshold. All landings shall be not less than 36" wide, measured in the direction of travel.

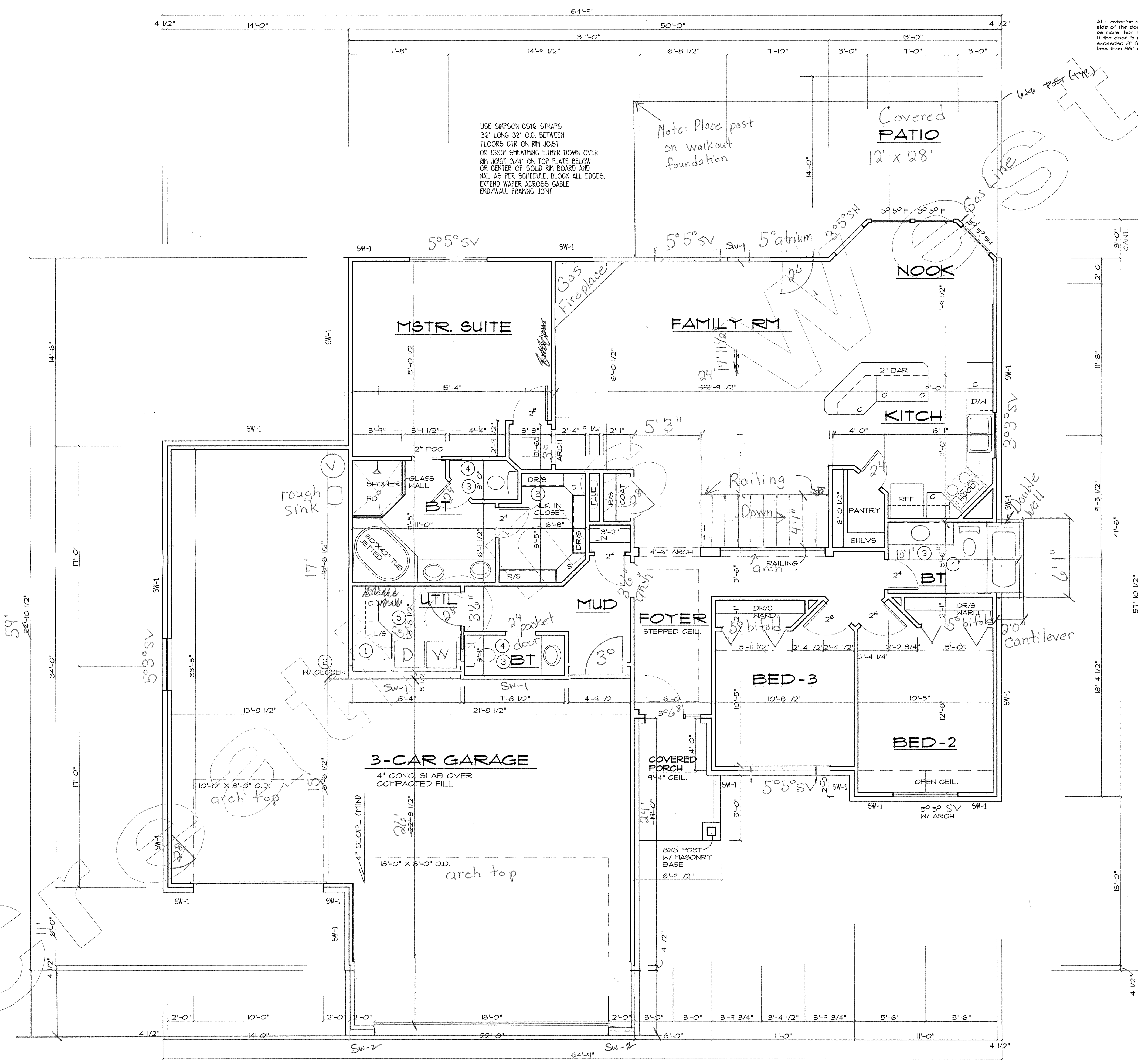

USE SIMPSON CS16 STRAPS  
 36" LONG 32" O.C. BETWEEN  
 FLOORS CTR ON RM JOIST  
 OR DROP SHEATHING EITHER DOWN OVER  
 RM JOIST 3/4" ON TOP PLATE BELOW  
 OR CENTER OF SOLID RM BOARD AND  
 NAIL AS PER SCHEDULE. BLOCK ALL EDGES.  
 EXTEND WATER ACROSS CABLE  
 END/WALL FRAMING JOINT

Note: Place post  
 on walkout  
 foundation

**FIRE PROTECTION:**  
 Provide 5/8" type 1/4" gyp. brd. on all the walls and ceilings of garage, nail @ 6" o.c. All beams and structural members shall be protected with 5/8" gyp. brd. with self closer. Door between garage and house shall be solid core wood or 1 1/2" labeled door not less than 1 3/4" air seal closer. Protect enclosed usable space under stairs with 5/8" gyp. brd. fire blocking at stud cavities that are greater than 8" o.c.

**SHEAR WALL NOTES**  
 ALL EXTERIOR WALLS AND VERTICAL SURFACES AT STEPS IN ROOF SHALL BE SHEATHED WITH 15/32" APA RATED 24/0 OR BETTER STRUCTURAL WOOD PANELS. BLOCK ALL HORIZ EDGES WITH 2" NOM. OR WIDER. 2" OR WIDER FRAMING AT ADJOINING PANEL EDGES AND NAILS SHALL BE STAGGERED WHERE 10d NAILS ARE SPACED 3' O.C. OR LESS. SHEATHING SHALL EXTEND CONTINUOUS FROM FLOOR TO TOP PLATE FRAMING ON UPPER EXT. WALLS. NAILS SHALL BE PLACED NOT LESS THAN 1/2" FROM EDGE OF PANEL AND DRIVEN FLUSH BUT SHALL NOT FRACTURE THE SURFACE OF THE SHEATHING. EXTEND SHEATHING OVER RM AND NAIL TO RM AND WALL PLATES 4" O.C.

**SHEAR WALL SCHEDULE**

TYPE	SHEATHING	NAIL	EDGE	FIELD	ANCHOR BOLTS
TYPICAL	7/16" ONE SIDE	8d	6" O.C.	10" O.C.	1/2" 32" O.C.
SW-1	7/16" BOTH SIDES	8d	4" O.C.	10" O.C.	1/2" 32" O.C.
SW-2	7/16" ONE SIDE	8d	4" O.C.	10" O.C.	1/2" 32" O.C.
SW-3	5/8" ONE SIDE	10d	4" O.C.	10" O.C.	1/2" 32" O.C.
SW-4	7/16" ONE SIDE, NAIL/SCREW DRYWALL	8d	4" O.C.	10" O.C.	1/2" 32" O.C.
PSW	PERFORATED SHEAR WALL (SEE DETAIL)				

BRACED WALLS; GUE AND NAIL SHEETROCK 7" O.C. BOTH SIDES  
 NOTE: STAPLES MAY BE SUBSTITUTED FOR 8d NAILS AT 1/2 SPACING  
 NOTE: SCREWS MAY BE SUBSTITUTED FOR NAILS IN DRYWALL

**FLOOR PLAN GENERAL NOTES:**  
 1. Plumbing wall 2x6 @ 16" o.c.  
 2. Attic access 22" x 30" with a switched light in attic space.  
 3. Exhaust fan, 50 CFM run exhaust duct to the outside.  
 4. Provide 30" min. width for the water closet and 24" clear in front.  
 5. Vent dryer to outside with 4" metal ducting, termination cap.

**GENERAL NOTES:**  
 Compliance with codes and ordinances governing the work shall be made and enforced by the general contractor. General contractor shall verify all existing conditions and dimensions prior to construction. Note that all written dimensions take precedence over scale. Manufacturer's specifications for installation of materials shall be followed. Workmanship throughout shall be of the best quality of the trade involved and the general contractor shall coordinate the work of the various trades to expedite the job in a smooth and continuous process.

**EXHAUST SYSTEM NOTES:**  
 Dryer exhaust systems shall convey the moisture to the outdoors and shall terminate on the outside of the building. Screens shall not be installed at the duct terminal. Ducts shall have a back draft stopper. The max. length of clothes dryer exhaust duct shall not exceed 25 feet from the dryer location to the wall or roof termination. The max. length of the ducts shall be reduced 2.5 feet for each 45 degree bend and 5 feet for each 90 degree bend.

**MAIN FLOOR PLAN**  
 SCALE 1/4"  
 1863 SQ. FT. MAIN LEVEL

House connection back flow prevention shall be installed on the discharging side a hose threaded outlet.

NOTE:  
 9'-0" WALLS HEIGHT (TYP)

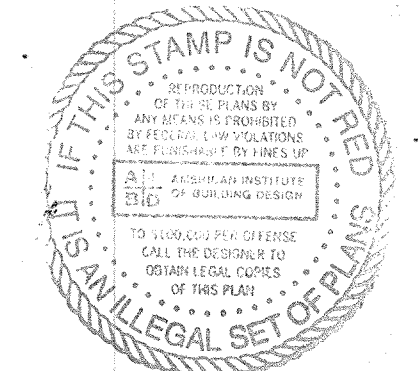
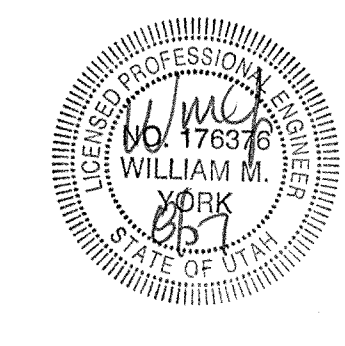

PLANNED FOR:  
**CRAYTHORNE CONST.**  
 LOT # 16, HARRISBURG, CLINTON, UTAH.

1664 N. 1000 WY.  
 Layton, Utah 84041  
 P. 801.525.6700  
 plans@creationswest.com

**CREATIONS WEST**  
 AFFLUENT ARCHITECTURE  
 WWW.CREATIONSWEST.COM

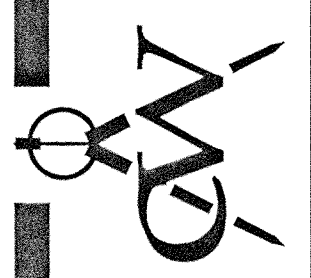

DATE: JUNE 14, 07  
 SHEET: 2

PLAN NUMBER  
**LR-1826-06CE**